

# UNIVERSITY OF CALIFORNIA, SANTA BARBARA

BERKELEY • DAVIS • IRVINE • LOS ANGELES • MERCED • RIVERSIDE • SAN DIEGO • SAN FRANCISCO



SANTA BARBARA • SANTA CRUZ

OFFICE OF DESIGN & CONSTRUCTION SERVICES and PHYSICAL FACILITIES

CONTRACTING SERVICES  
Building 439  
Santa Barbara, California 93106-1030  
Telephone (805) 893-3356  
Fax (805) 893-8592

**SENT VIA:**  FAX ON THIS DATE  
 HAND DELIVERY ON THIS DATE  
 FEDERAL EXPRESS ON THIS DATE  
 UNITED PARCEL SERVICE ON THIS DATE

HOLDERS OF PLANS AND SPECIFICATIONS:

Burnham Laboratory, BioSciences II, Bldg 571  
Project No. FM060653S/981510

**Addendum No. 1**

March 2, 2007

Enclosed is **ADDENDUM NO. 1** to the Construction Documents on the above-captioned project.

Bid date is **Tuesday, March 20, 2007 at 2:30 P.M.** to be held at:

CONTRACTING SERVICES  
Facilities Management, Bldg. 439,  
Door #E, Reception Counter  
University of California, Santa Barbara  
Santa Barbara, CA 93106-1030.

Late arrivals shall be disqualified. Please allow time for unforeseen traffic delays, securing a parking permit and potential parking problems.

A handwritten signature in black ink, appearing to read "Anna Galanis".

Anna Galanis  
Director, Contracting Services

ADDENDUM NUMBER 1

to the

CONSTRUCTION DOCUMENTS

MARCH 2, 2007

**GENERAL**

The following changes, additions or deletions shall be made to the following document(s) as Indicated; all other conditions shall remain the same.

**I. SPECIFICATIONS**

Item No.

1. Section 01014- "CONTRACTORS USE OF THE PROJECT SITE".Part 1, GENERAL; "Paragraph 1.02., WORK HOURS AND DAYS": **Add "B"** to read as follows: "Removal and erection of wall between Rooms 3121 and 3123 shall be conducted on a scheduled weekend".
2. Section 08710- "FINISH HARDWARE".Part 2, PRODUCTS; "Paragraph 2.8., Keying Requirements";"A.": **Revise** sentence 3 to read:  
"3. Contractor will furnish and install keyed permanent cores at completion of construction. Contractor shall deliver permanent cores to the University for keying."
3. Section 09650 - "RESILIENT FLOORING"; Part 3, EXECUTION, "Paragraph 3.03, Installation";"E", Sheet Material": **Revise** sentence 2 to read:  
"2. Joints: Chemically or heat weld. All vinyl coved base shall have mitered welded joints."

**II. DRAWINGS**

Item No.

1. DRAWING NO. A2.0 (DEMOLITION PLAN); **Add** the following keynote:  
"13. Removal and erection of wall between Rooms 3121 and 3123 shall be conducted on a scheduled weekend. Plastic sheeting shall be used to protect office contents."
2. DRAWING NO. A2.1 (PARTIAL FLOOR PLAN); " Room 3115 "; Provide furred out wall per attached Drawing **AD-1** to accommodate heating piping shown on sheet P2.2.

3. DRAWING NO. A3.0(REF CLNG PLAN); "Rooms 3106A & 3106B: Provide 24" X 24" access panels as shown on attached Drawing **AD-2**.
4. DRAWING NO. A5.0, SCHEDULE: **Replace** Door Schedule with Door Schedule on attached Drawing **AD-3**.
5. DRAWING NO. A6.0 (PARTITIONS & DETAILS): **Replace** existing Drawing A6.0 with attached Drawing A6.0 in its entirety:
6. DRAWING NO. A7.0 (DETAILS): Delete detail 11
7. DRAWING NO. M1.0 (GENERAL NOTES) Note "20": **Revise** to read as follows:  
  
"20. Fire stopping shall be per specification section 07840 and shall conform to campus EH&S criteria and factory UL specifications for fire stopping  
Both sides of new and existing penetrations through walls/floors or other penetrations require fire stopping."
8. DRAWING NO. M3.1, Exhaust & Makeup Air Schematic Diagram: **Replace** existing Drawing M3.1 in it's entirety with attached Drawing M3.1 (Remodel Roof Plan).
9. DRAWING NO. P1.0 (SCHEDULES, LEGENDS AND GENEAL NOTES): ": **Delete** note #7 and replace it with the following attached drawing **AD-4** (fixture schedule).
10. DRAWING NO. FA2.0 (FIRE ALARM PLAN); "Keynotes", #5: Note #5 shall apply to the fire horn strobe located in room 3106 on the south facing wall.
11. Add the following Drawings:  
  
AD-1 Floor Plan – Third Floor Dated 3/1/2007  
AD-2 Reflected Ceiling Plan – Third Floor Dated 3/1/2007  
AD-3 Door Schedule Dated 3/1/2007  
AD-4 Sink Schedule/Fixture Schedule Dated 3/1/2007  
M3-1 Remodel Plan – Roof Dated 1/12/2007  
A6.0 Partitions, Details Dated 1/12/2007

END OF ADDENDUM NO. 1

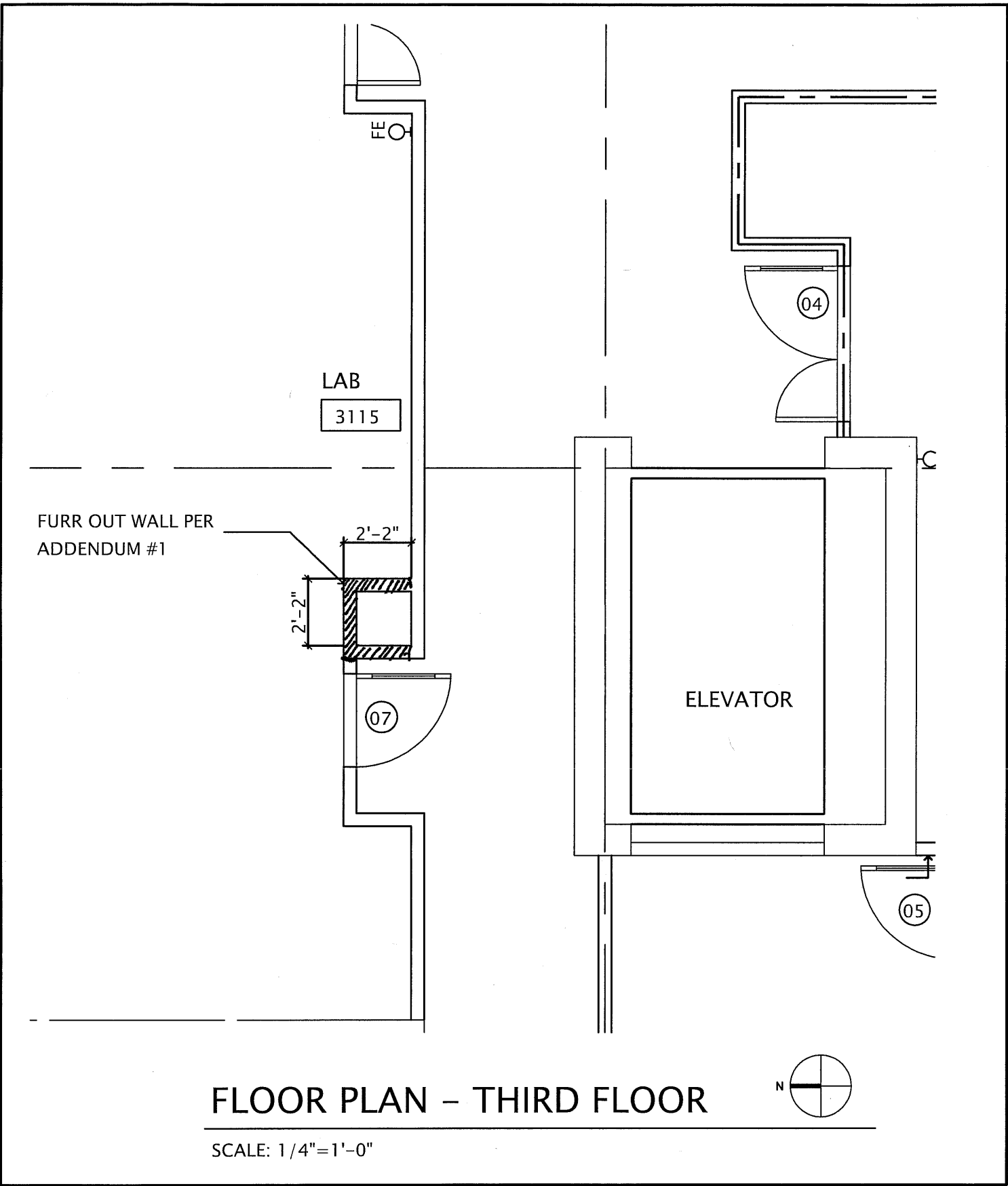

# FLOOR PLAN - THIRD FLOOR



SCALE: 1/4"=1'-0"

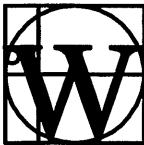

**CHARLES WOODBURN**  
 architect  
 232  
 orangeville 2a  
 santa barbara  
 california  
 93101  
 805.966.8288

**BURNHAM LABORATORY IN BIO II**  
 UNIVERSITY OF CALIFORNIA, SANTA BARBARA  
 PROJECT NO. FM060653S/981510

03/01/07 Job #

drawn by checked by

AD-1

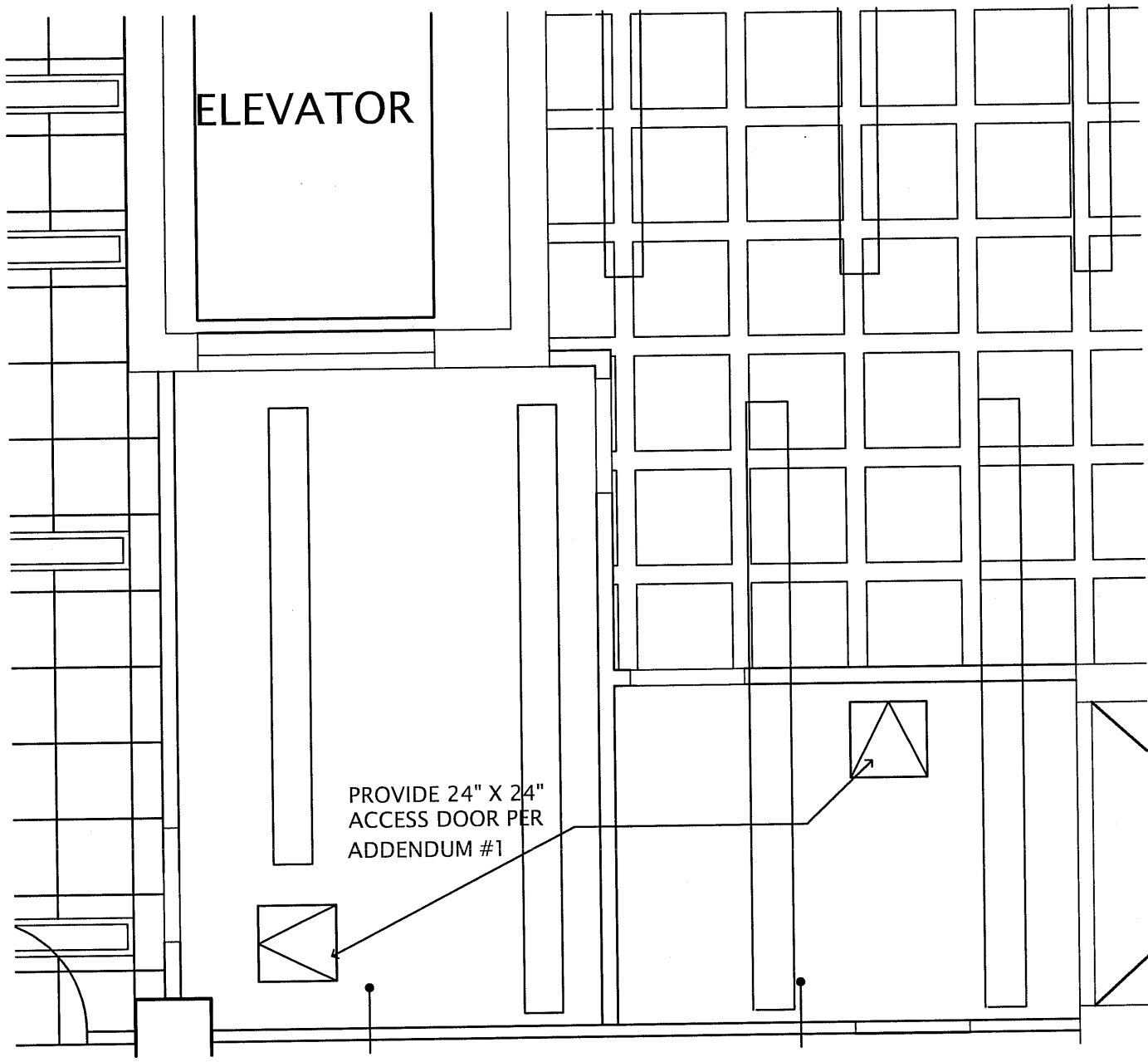

ELEVATOR

PROVIDE 24" X 24"  
ACCESS DOOR PER  
ADDENDUM #1

# REFLECTED CEILING PLAN - THIRD FLOOR

SCALE: 1/4"=1'-0"

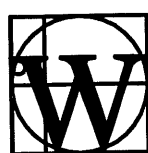

CHARLES WOODBURN  
architect  
232  
moores suite 2a  
santa barbara  
california  
93101  
805.966.6266

BURNHAM LABORATORY IN BIO II  
UNIVERSITY OF CALIFORNIA, SANTA BARBARA  
PROJECT NO. FM060653S/981510

03/01/01	Job #
Drawn by	Checked by

AD-2

# DOOR SCHEDULE

DOOR NUMBER	OPENING SIZE (WIDTH x HEIGHT) TYPICAL DOOR HEIGHT = 7'-0" UON	DOOR TYPE (SEE CODE LIST)	DOOR CONSTRUCTION (SEE CODE LIST)	FRAME CONSTRUCTION (SEE CODE LIST)	FACING & FINISH (SEE CODE LIST)	CLASS (SEE CODE LIST)	DETAIL(S) (SHT A7.0 UON) TYPICAL DETAILS ARE 1/A7.0 UON	HARDWARE GROUP SPECIFICATION SECTION 08710	RATING, IF REQ'D (IN MINUTES)	REMARKS (SEE NOTES)
01	PAIR 3'-0" / 2'-0" X 7'-0"	A	SC	HM	WT	TP		07	20	1
02	3'-0" X 7'-0"	B	SC	HM	WT	TP		01	20	2
03	3'-0" X 7'-0"	B	SC	HM	WT	TP		01	20	2
04	PAIR 3'-0" / 2'-0" X 7'-0"	A	SC	HM	WT	TP		07	20	1
05	3'-0" X 7'-0"	B	SC	HM	WT	TP		04	NR	
06	3'-6" X 7'-0"	B	SC	HM	WT	TP		06	20	1
07	3'-0" X 7'-0"	B	SC	HM	WT	TP		05	20	1
08	3'-0" X 7'-0"	B	SC	HM	WT	TP		02	20	3
09	3'-0" X 7'-0"	B	SC	HM	WT	TP		03	NR	

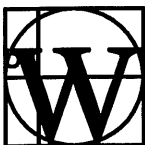

CHARLES WOODBURN  
architect  
232  
Encino, Suite 2a  
Santa Barbara  
California  
93101  
805.966.9286

BURNHAM LABORATORY IN BIO II  
UNIVERSITY OF CALIFORNIA, SANTA BARBARA  
PROJECT NO. FM060653S/981510

08/01/98 Job #  
Drawn by checked by

AD-3

# SINK SCHEDULE

TAG	SINK DESCRIPTION & MODEL NUMBER	SINK SIZE
SK1	DROP-IN STAINLESS STEEL SINGLE BOWL SINK # SX-1721-A-GR	18"x14"x10-1/2" I.D.
<b>CUPSINK &amp; ACCES. DESCRIPTION &amp; MODEL NUMBER</b>		
CS4	EPOXY RESIN CUPSINK 6x3x4 DEEP OUTLET IS INTEGRAL WITH SINK	
<b>FIXTURE SCHEDULE</b>		
TAG	SERVICE DESCRIPTION	MODEL NUMBER
<b>WATER FIXTURES BY WATERSAVER(QDP)</b>		
F1	DECK MOUNTED HOT & COLD WATER FIXTURE w/BLADE HANDLES	L424-TIP/L424-9VB
DI	DISTILLED AND DEIONIZED WATER FIXTURE	L7833
<b>SERVICE FIXTURES BY WATERSAVER(QDP)</b>		
G	DECK MOUNTED GAS BALL VALVE	L4200-132SWA
A	DECK MOUNTED AIR BALL VALVE	L4200-132SWA
V	DECK MOUNTED VAC BALL VALVE	L4200-132SWA
G1	DECK MOUNTED GAS BALL VALVE	L4200-131SWA
A1	DECK MOUNTED AIR BALL VALVE	L4200-131SWA
V1	DECK MOUNTED VAC BALL VALVE	L4200-131SWA
<b>EMERGENCY FIXTURES BY WATERSAVER(QDP)</b>		
EW	DECK MOUNTED EYEWASH	EW1022
<b>EMERGENCY SHOWER BY WATERSAVER</b>		
SS1	BARRIER-FREE COMBINATION EMERGENCY SHOWER	SSBF2150MOD

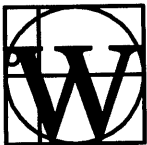

CHARLES WOODBURN  
architect  
232  
5th Street Suite 20  
Santa Barbara  
California  
93101  
805.966.6286

BURNHAM LABORATORY IN BIO II  
UNIVERSITY OF CALIFORNIA, SANTA BARBARA  
PROJECT NO. FM060653S/981510

03/01/01 Job #  
Drawn by checked by

AD-4